



Highlights Happening Here at Headquarters

**July/August
2021**

Inside this issue:

4-H Calendar	2
Communications from Extension Office	2
Important Dates	3
4-H Handbook	3
4-H Fairbook/Flyer	3
YQCA - Reminder	3
Record Book/Project Check-in	4
Open Judging	4
Livestock Auction	4
Attention Live Animal Exhibitors	5
Swine Exhibitor Information	5
Thank you to 4-H Supporters!	5
Fair Office	5
Fair Clean Up Day	5
4-H Creative Writing	6
4-H Sewing, Consumer Clothing, & Fashion Revue	6
Don't Forget to Say "Thank You"!	6
4-H Building Check-out	6
COVID Reminders	7
Where Do I take My Projects? - Maps	7-9

Hello everyone!

It is officially summer here in White County and that means that the 2021 White County 4-H Fair is just around the corner! I hope you are all as excited as I am about the White County 4-H Fair!

As the Fair approaches, please remember to thank those individuals who help with the 4-H program and work hard all year to make the Fair a success. The support of the many 4-H volunteers, sponsors, and members of the community help make the White County 4-H program as great as it is.

There is a lot of important information about upcoming events and deadlines included in this newsletter. Be sure to read through everything and contact the White County Extension Office with any questions.

As you read through this newsletter please take note of several important pieces of information. A couple of the highlights include:

- **Upcoming deadlines**
- **Project Check-in and Fair Activities**

If you have any questions or concerns, please do not hesitate to call the Extension Office at (219) 984-5115 or send me an email at furrer@purdue.edu. Please let me know if there is anything that I can do to help make your 4-H experience successful and memorable!

Sincerely,

Miranda Furrer

Miranda Furrer
Extension Educator
4-H Youth Development
furrer@purdue.edu
<https://extension.purdue.edu/white>



PURDUE
UNIVERSITY

PURDUE UNIVERSITY COOPERATIVE EXTENSION SERVICE
White County

· 12 N 25 E · Reynolds, IN 47980-8091 ·

(219) 984-5115 ·

Purdue University, Indiana Counties and U.S Department of Agriculture Cooperating
An Affirmative Action/Equal Opportunity Institution

4-H Calendar

July

- 1 Shooting Sports Meeting 6:30 p.m., SAFE club, Monon
- 5 Independence Day Holiday – Extension Office Closed
- 6 Coding Club 4:30 pm., 4-H Reynolds Building
- 6 Electric Workshop, REMC Shop @ 6 pm
- 7 Fair Committees Meeting, 7 pm, 4-H Building, Reynolds
- 7 Horse & Pony Workshop, Reynolds
- 10 Shooting Sports Meeting 6:30 p.m., Camp Buffalo Boy Scout Camp
- 10 Swine Barn Clean up @ 8 am
- 11 Beef Barn Clean up @ 2:00 p.m.
- 12 West Point 4-H Club Meeting, 7 p.m., Meadow Lake Church, Wolcott
- 12 Ag Association, Building Set-up 6 pm ; meeting 7 pm, 4-H Building, Reynolds
- 12 Junior Leaders, 6:30 pm, 4-H Building, Reynolds
- 13 Horse & Pony, 7 pm, 4-H Building, Reynolds
- 13 Union Township Meeting 6:30 p.m., Zion Bethel Church Monticello
- 14 Horse & Pony Workshop, Reynolds
- 14 Princeton Township Meeting 5:30 p.m., Tri-County Intermediate, gym, Wolcott,
- 16-22 White County Fair
- 21 Bottle Calf SPARK CLUB, 7 p.m., 4-H Building, Reynolds

August

- 4 Ag Association, 7 pm, 4-H Building, Reynolds
- 6-22 Indiana State Fair
- 9 West Point 4-H Club Meeting, 7 p.m., Meadow Lake Church, Wolcott
- 10 Union Township Meeting 6:30 p.m., Zion Bethel Church Monticello
- 11 Princeton Township Meeting 5:30 p.m., Tri-County Intermediate, gym, Wolcott,

If you have any 4-H events or activities that you would like to add to the White County Extension calendar, please contact the White County Extension Office at (219) 984-5115.

Communications from the White County Extension Office

Have you been receiving the emails and letters that we send out? Emails that are sent out are often sent through 4HOnline and may have 4HOnline as the sender. If you are not receiving our emails or letters, please let us know so that we can double check your information. We send out a lot of important reminders - be sure to watch for these!

White County 4-H Important Dates

- ☑ **June 30th** - Creative Writing Projects due to the Extension Office by 4:00 p.m. so they can be judged prior to the Fair
- ☑ **July 1** - Live Animal Fair Entries due in **online FairEntry program by midnight**. Live animal Project Manuals, Educational Activities, and Record Sheets (if applicable) due in the **Extension Office by 4 p.m.**
- ☑ **July 1** - Non Live Animal Fair Entries due in **online FairEntry program by midnight**.
- ☑ **July 6–** Music and Communications Judging, St. James Lutheran Church, 7 pm.
- ☑ **July 10** - Sewing, Consumer Clothing, and Fashion Revue Judging
- ☑ **July 13-15** - Project Check-in and Pre-Fair Judging - See the Fair Book for details!
- ☑ All Exhibit Hall/Building Project Manuals/Record Sheets/Educational Activities due when Projects are checked in at the Fair. See the 2021 White County 4-H Fair Book for details!
- ☑ **July 16-22** - 2021 White County 4-H Fair!
- ☑ **July 23** - 4-H Fairgrounds Clean-up, 8:00 a.m.; Free breakfast served by Co-Alliance for all 4-H Members, Leaders, and Volunteers who help with Clean-up
- ☑ **July 29** - All State Fair entries, except Food Baked or Food Preserved exhibits are due to the Extension Office by 3 pm.
- ☑ **August 4** - All State Fair Food Baked or Food Preserved exhibits are due to the Extension Office by 8:15 AM for **immediate** delivery to State Fair
- ☑ **August TBD-** 4-H Fair Evaluation Meeting, 7 p.m., 4-H Building, Reynolds
- ☑ **August 24** - All State Fair 4-H Exhibits available for pick up in the Extension Office
- ☑ **September 1–** All 4-H Fair Exhibit Committees meeting, 7 p.m., 4-H Building (review rules/guidelines for 2022)
- ☑ **October 1** - 4-H Enrollment begins for the 2021-2022 4-H Year

2021 White County 4-H Handbook

The White County 4-H Handbook is now available on the Purdue Extension - White County website at <https://extension.purdue.edu/White/article/35837>. The Handbook outlines all of the rules for the White County 4-H program, as well as all of the requirements for Projects and Exhibits. There have been several changes made for this year. **Please read the 2021 requirements before beginning any project.**

2021 White County 4-H Fair Flyer/Fairbook

The 2021 White County 4-H Fair flyer is now available! The Fair flyer is a great resource for 4-H families and includes the **Pre-Fair Project Check-in and Judging Schedule**, and the **Schedule of Fair Activities and Shows!** If you have not yet received a copy of the Fairbook, you can pick one up at the Extension Office or you can download a copy from the Purdue Extension - White County webpage.

YQCA - Reminder

There are no more in person trainings. If you still need to get this done, you will have to do it online. This is a requirement and you will **NOT** be allowed to show if you don't get this done. It needs to be done by **JULY 1**.

Search YQCA, and log in through 4HOnline.

4-H Record Book/Project Check-In

Most 4-H projects have a record sheet and an activity manual/educational activities, which must be completed and turned in to complete and exhibit the project. Please carefully read the information below to be sure that you turn your manuals and record sheets in at the correct location and time.

4-H Building Projects:

1. Bring your 4-H Building project record sheets and/or manuals to the “Young McDonalds Farm” building (located on the west side of 4-H Building). Please be prepared to show the activities you have completed from your manual(s) & your completed record sheet(s). (A page tab or paper clip is a good way to mark your completed activities prior to check-in).
 - a. Turn in your green and white 4-H record folder along with the complete “My Record of Achievement” with the first 4-H record that is turned in.
 - b. You will not be able to check-in without a completed activity manual and/or record sheet.
2. Once your record sheets/activity manuals have been reviewed and entry check-in is complete, you will receive an exhibit tag for your project(s).
3. Take your exhibit tag and project to the appropriate project check-in table in the 4-H Building. Projects will not be accepted without an exhibit tag.
4. You may bring record sheets/activity manuals for later projects check-in times, and receive the exhibit tag for that project(s). However, you **may not** check-in the project until the appropriate time. You must have the exhibit tag before checking in the project.

Live Animal Projects: Completed educational activities/manuals were due for Beef, Dairy Beef, Dairy, Cats, Dogs, Goats, Horse & Pony, Llamas, Poultry, Sheep, Small Animals, and Swine by **July 1 at 4:00 p.m.** Any educational activities/manuals not yet turned in should be turned into the Extension Office to get credit for completing the project. Members will still be eligible to exhibit at the Fair, however there will be a late fee (See the 2021 White County 4-H Handbook for details.)

Open Judging

All judging of building projects at the White County 4-H Fair are OPEN! What does that mean?

All White County 4-H Building projects (also known as “static” projects) are judged in an OPEN format. But what exactly does that mean? In open judging, exhibitors are invited to talk to the judges about their projects while they are being judged and answer any questions the judges may have. Spectators, such as family members and project helpers, may also be present to listen to the comments, but they are not allowed to engage in conversation with the judge. In contrast, in closed judging, exhibitors and spectators are not allowed to be present during judging. In both open and closed judgments, the judges complete comment sheets or scorecards which are given to the exhibitors later during the Fair. Attending open judging, interacting with the judges, and listening to the comments made to other exhibitors provides an invaluable educational opportunity, and we hope all static project exhibitors will take advantage of this opportunity. Please refer to the Fair Flyer or Fair Book for a full schedule of check-in and judging dates/times, highlight those that pertain to you, and plan to be present for your OPEN judgments. (Note: Mini 4-H is judged in a closed format with all exhibitors receiving a blue ribbon and brief comment cards.)

2021 White County 4-H Fair Livestock Auction

The White County 4-H Auction will be held on **Thursday, July 18th**, and will begin at **1 p.m.**, with the buyer dinner starting at **12 p.m.** Animals will be sold on a premium, not per pound, basis.

4-H Livestock members are reminded to declare their animal for the livestock auction during check-in or weigh-in at the Fair. Be sure to check the 2021 White County 4-H Handbook for Auction Rules. If you would like to donate proceeds from your sale toward a 4-H related organization, a charity, or a scholarship fund of your choice, don't forget to fill out the “Notice of Donation” statement on the Sale Declaration form. **No Leased animals may be sold in the auction.**

2021 Order of Sale: Swine, Rabbits, Sheep, Goats, Beef, Poultry

Attention all 4-H Live Animal Exhibitors!

Please read this information very carefully!

By this time, you should be entering your Live Animal projects (Cats, Dogs, Small Animals, Beef, Dairy, Dairy Beef, Goats, Horses, Llamas, Sheep, Swine, Poultry, Rabbits) online in the FairEntry program. You should also be turning in your Live Animal project record sheets and educational activities to the Extension Office **by 4 pm on July 1st**. **If you do not do these things by July 1st, and still wish to exhibit at this year's White County 4-H Fair, please contact the White County Extension Office. You will still be eligible to exhibit at the Fair, but you will be subject to a late fee.** Please refer to the White County 4-H Exhibition Requirements in the 2021 White County 4-H Handbook for more information about the late policy.

A few additional notes:

- All Cattle and Swine will be required to have an official form of identification in place during the Fair, as required by the Indiana Board of Animal Health. For both Cattle and Swine, this official identification can be the 840-RFID tag. The list of Official Forms of Animal Identification can be found in the "Animal Health Requirements for Exhibition of Domestic Animals in Indiana in 2021" section of the 2021 White County 4-H Handbook.
- Some animals have additional Animal Health Requirements (such as vaccination requirements). Be sure to read through the White County 4-H Handbook to ensure you are meeting all of the requirements and have the necessary paperwork.

Swine Exhibitors - Important Information

All Swine Exhibitors selling their animal at Fair must complete the County Fair Swine Affidavit and turn it in at Fair check-in. Only one form is needed per exhibitor, as long as the Premise ID is the same for each animal on the form. Forms will be handed out at check-in.

Swine Barn Set Up

All 4-H Swine Project members are asked to join the 4-H Swine Committee in cleaning and setting up the Swine Barn here at the White County 4-H Fairgrounds on **Saturday, July 10th at 9:00 a.m.** Bring your shovels and brooms! It takes a lot of work to get the barn ready for Fair and the more people who help, the faster it will go. Please contact a White County 4-H Swine Committee member with any questions.

Thank You!

We would like to extend a huge thank you to everyone who has supported the White County 4-H program and the White County Agricultural Association so far in 2021! Thank you to everyone who has made a donation -your donations go a long way in helping run the 4-H program and the White County 4-H Fair. We also want to thank everyone who has donated their time and hard work on many different projects so far this year. Our program could not be nearly as successful without all of you!

Thank you all again for everything you do to make our program great!

Fair Office

The 4-H Fair Office will be in operation during the week of the Fair and is located next to the First Aid Building near the Flag Pole by the Arena. During the Fair, the Extension Office will be closed. All questions and concerns during that time should be brought to the Fair Office.

Fair Clean Up Day

All 4-H Members, families, and volunteers are asked to help clean up the 4-H Fairgrounds after the Fair on Friday, July 22nd at 8:00 a.m. A free breakfast will be provided by Co-Alliance for all who help. We know everyone is tired after the Fair, the more people that we get to come help, the faster it will go!

4-H Creative Writing Projects

All 4-H Creative Writing projects and the Creative Writing Record Sheet are due to the White County Extension Office by **4:00 p.m. on Wednesday, June 30th**. This will allow our judge to spend the time needed to judge these projects prior to the Fair. Creative Writing projects also need to be entered in FairEntry at <http://whitecountyindiana.fairentry.com> by **July 1st**.

4-H Sewing, Consumer Clothing, & Fashion Revue

- 2021 Sewing, Consumer Clothing, & Fashion Revue Judging is scheduled for **Saturday, July 10th** at the 4-H Building in Reynolds.
 - 8-8:30 a.m.: Sewing Project Check-In
 - 9:00 a.m.: Open Judging of Sewing Projects (wearable and non-wearable items)
 - 9:30-10 a.m.: Consumer Clothing Check-In
 - 10:00 a.m.: Open Judging of Consumer Clothing
 - 11:30 a.m. (approximately): Grade 3 members practice modeling wearable projects
 - 12:00 p.m.: Lunch
 - 12:30 p.m.: Fashion Revue Judging (order to be determined); only 4-H members, leaders, and parents may attend this private judging day.
- Each Sewing exhibit needs to have a completed Sewing Project Exhibit Card included with the project.
- Everyone is invited to attend the Public Fashion Revue on **Saturday, July 17th at 6:00 p.m.** at the 2021 White County 4-H Fair.
- Refer to the letter that was mailed to all Sewing, Consumer Clothing, & Fashion Revue members for more information. If you did not receive your letter, please contact the White County Extension Office.

4-H Members: Don't Forget to Say "Thank You!"

4-H members are **highly encouraged** to write thank you notes to award sponsors and other individuals who have helped you with your 4-H projects. Some of these individuals may include parents, siblings, 4-H leaders, auction buyers, Ag Association members, other 4-H members, or other 4-H volunteers. Let's show White County 4-H Supporters that we really do care about all of the things they do for us in the White County 4-H pro-

4-H Building Project Check-out

4-H members and parents are reminded that 4-H Building projects may be checked out between **7 p.m. and 8 p.m. on Thursday, July 22nd**. **No early check outs are allowed.**

Please plan your schedule accordingly and make arrangements with someone else to pick up your projects if you are unable to do so at the designated time. Please remember to pick up your projects! We do not have room to store leftover items.

COVID-19 Restrictions

We are thankful to be able to have a more 'normal' fair this year! However, there are still some COVID restrictions to keep in mind. Social distancing and wearing face coverings is recommended, and please wash/sanitize your hands frequently. During building project judgments, judges, volunteers and staff will be asked to wear a face covering. There will be no more than 20 people gathered at any judging area inside the building and families waiting are asked to bring lawn chairs and spread out across the fairgrounds.

Where Do I Take My 4-H Project?

1. Bring your 4-H Building project record sheets and/or manuals to the “Young McDonalds Farm” building (located on the west side of 4-H Building). Please be prepared to show the activities you have completed from your manual(s) & your completed record sheet(s). (A page tab or paper clip is a good way to mark your completed activities prior to check-in).
 - a. Turn in your green and white 4-H record folder along with the complete “My Record of Achievement” with the first 4-H record that is turned in.
 - b. You will not be able to check-in without a completed activity manual and/or record sheet.
2. Once your record sheets/activity manuals have been reviewed and entry check-in is complete, you will receive an exhibit tag for your project(s).
3. The maps below show where your 4-H Projects will be checked-in at the Fair. Look over this map, find your project, and you will know where to enter your project on check-in day. Look in your 4-H Fair book to find the specific dates and times of project check-in. ****Please note that there will be a lot of people checking in projects***

during this time. Be prepared for long wait times.*

4-H Building Check-In Schedule

Tuesday morning July 13th 8-9 am and

Tuesday evening July 13th, 4-5:45 pm

NORTH 4-H BUILDING

Enter NW door

Woodworking - N1

Enter NE door

Farm/Construction/Train Toy Scene - N2

SOUTH 4-H BUILDING

Enter S Door

Collections - S1

Genealogy - S1

Records of Achievement - S1

Scrapbook - S1

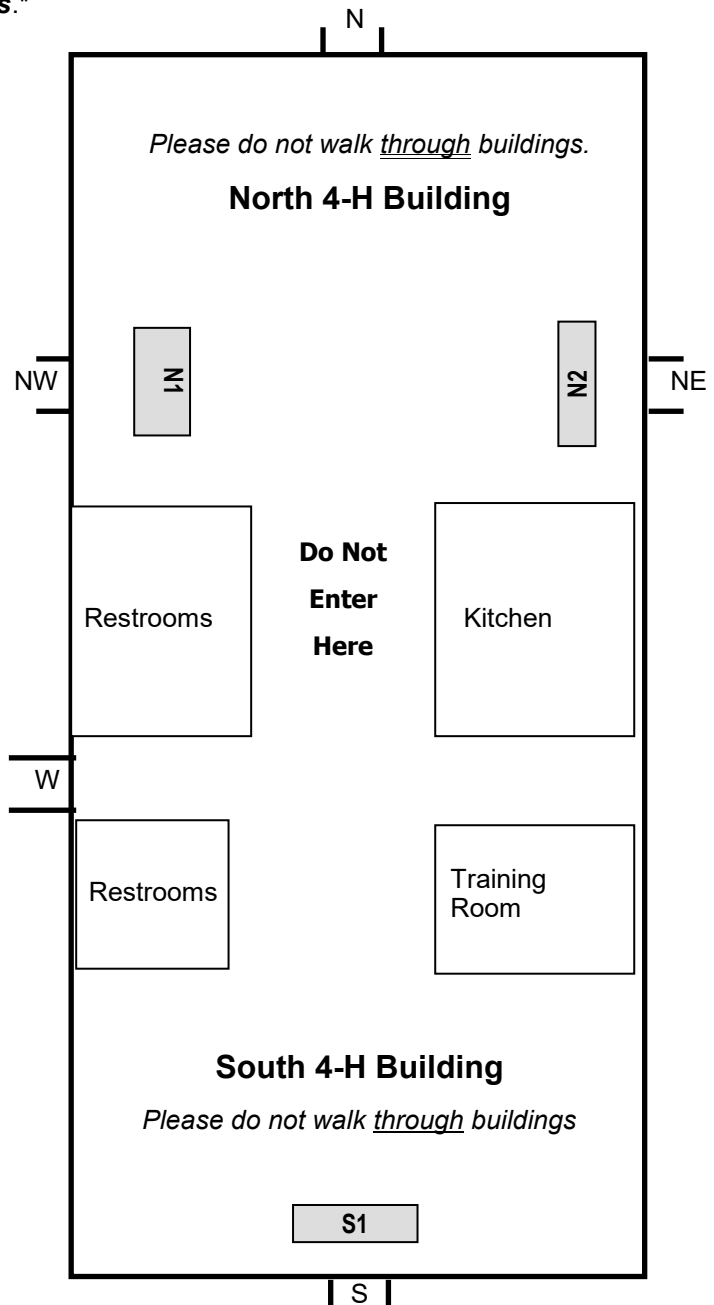

Where Do I Take My 4-H Project?

1. Bring your 4-H Building project record sheets and/or manuals to the “Young McDonalds Farm” building (located on the west side of 4-H Building). Please be prepared to show the activities you have completed from your manual(s) & your completed record sheet(s). (A page tab or paper clip is a good way to mark your completed activities prior to check-in).
 - a. Turn in your green and white 4-H record folder along with the complete “My Record of Achievement” with the first 4-H record that is turned in.
 - b. You will not be able to check-in without a completed activity manual and/or record sheet.
2. Once your record sheets/activity manuals have been reviewed and entry check-in is complete, you will receive an exhibit tag for your project(s).
3. The maps below show where your 4-H Projects will be checked-in at the Fair. Look over this map, find your project, and you will know where to enter your project on check-in day. Look in your 4-H Fair book to find the specific dates and times of project check-in. ****Please note that there will be a lot of people checking in projects***

jects

during this time. Be prepared for long wait times.*

4-H Building Check-In Schedule

**Tuesday evening July 13th 6:30-8 p.m. and
Wednesday morning July 14th, 8-8:30 a.m.**

NORTH 4-H BUILDING

Enter N door

- Taxidermy - N3
- Entomology - N3
- Geology - N3
- Beekeeping - N3
- Electric - N3

Young McDonalds Farm (outside)

Field Crops

SOUTH 4-H BUILDING

Enter W Door

- Mini Projects (last name A-L) -
T1 (in Hallway between rooms)
- Foods - W1
- Home Environment - W1
- Child Development - W1
- Leadership - W1
- Health - W1
- Sports- W1



Where Do I Take My 4-H Project?

1. Bring your 4-H Building project record sheets and/or manuals to the “Young McDonalds Farm” building (located on the west side of 4-H Building). Please be prepared to show the activities you have completed from your manual(s) & your completed record sheet(s). (A page tab or paper clip is a good way to mark your completed activities prior to check-in).
 - a. Turn in your green and white 4-H record folder along with the complete “My Record of Achievement” with the first 4-H record that is turned in.
 - b. You will not be able to check-in without a completed activity manual and/or record sheet.
2. Once your record sheets/activity manuals have been reviewed and entry check-in is complete, you will receive an exhibit tag for your project(s).
3. The maps below show where your 4-H Projects will be checked-in at the Fair. Look over this map, find your project, and you will know where to enter your project on check-in day. Look in your 4-H Fair book to find the specific dates and times of project check-in. ****Please note that there will be a lot of people checking in projects***

during this time. Be prepared for long wait times.*

4-H Building Check-In Schedule

**Wednesday evening July 14th 6:30-8 p.m. and
Thursday morning July 15th, 8-8:30 a.m.**

NORTH 4-H BUILDING

Enter NW door

- Floriculture - N1
- Gardening - N1
- Robotics - N1
- Small Engines - N1

Enter N door

- Photography - N2

SOUTH 4-H BUILDING

Enter W Door

- Mini Projects (last name M-Z)- T1 (in Hallway between rooms)
- All Poster Projects - T1 (in Hallway between rooms)
- Gift Wrapping - W1
- Aerospace - W1
- Any Other Models - W1
- Models - W1

Enter S Door

- Fine Arts - S1
- Cake Decorating - S2
- Any Other Craft - S3
- Needle Craft - S3
- Up Cycling - S3



PURDUE
UNIVERSITY

PURDUE UNIVERSITY COOPERATIVE EXTENSION SERVICE
White County
12 N 25 E
Reynolds, IN 47980-8091
Cooperating with U.S. Department of Agriculture

NONPROFIT ORG.
U.S. POSTAGE
PAID
REYNOLDS, INDIANA
PERMIT No. 15

White County

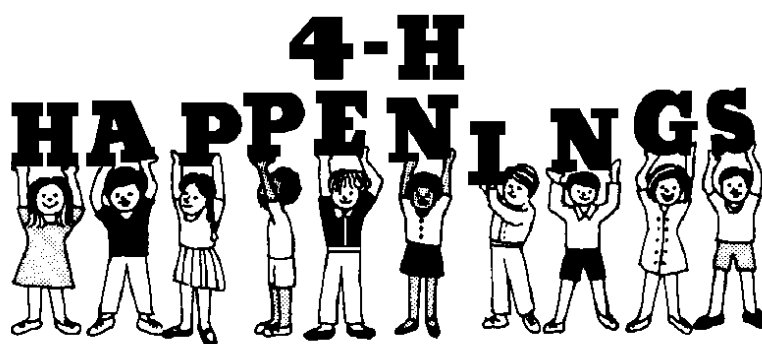

July/August 2021